



Model ST1009 Bed Extension for ST1008 Instruction Sheet

Phone #: (360) 734-3482 • Online Tech Support: tech-support@shopfox.biz • Web: www.shopfox.biz

Introduction

The Model ST1009 Bed Extension extends the bed length of the Model ST1008 10" x 15" Benchtop Wood Lathe, increasing the distance between centers from 15" to 38".

Inventory (Figure 1)

- A. Bed Extension 1
- B. Rubber Feet..... 2
- C. Cap Screws M8-1.25 x 35 4
- D. Flat Washers 8mm 4
- E. Hex Wrench 6mm 1

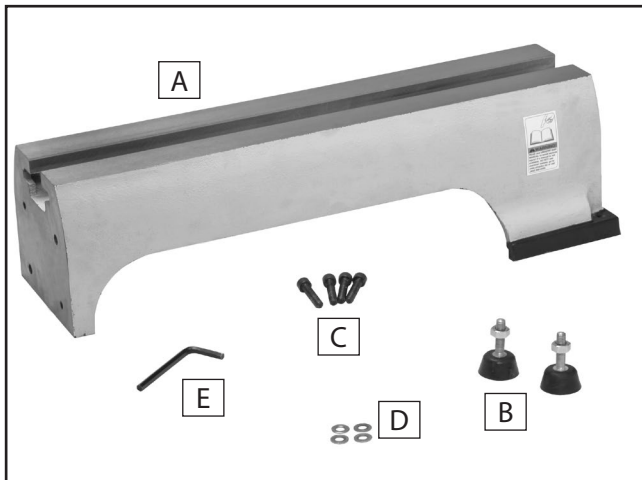

Figure 1. Model ST1009 inventory.

Installation

1. Thread rubber feet into bottom of bed extension.
2. Attach bed extension to tailstock-end of ST1008 bed, using the four provided cap screws and flat washers (see **Figure 2**). Finger tighten only for now.

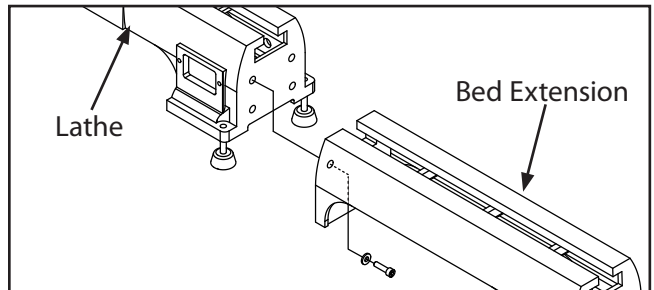

Figure 2. Joining lathe and bed extension.

3. Center tailstock over bed extension and lathe (see **Figure 3**), and then tighten tailstock lock lever. This will force bed extension into alignment with lathe bed.

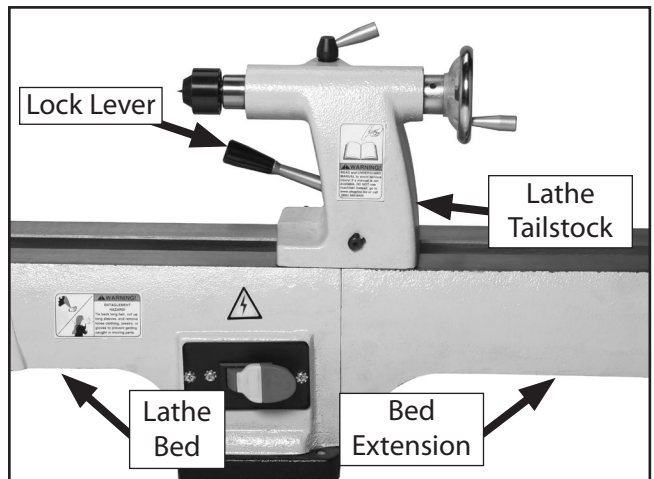

Figure 3. Tailstock centered over extension table and lathe bed.

COPYRIGHT © MARCH, 2016 BY WOODSTOCK INTERNATIONAL, INC.

WARNING: NO PORTION OF THIS MANUAL MAY BE REPRODUCED IN ANY SHAPE OR FORM WITHOUT

THE WRITTEN APPROVAL OF WOODSTOCK INTERNATIONAL, INC.

#18061DN

Printed in China

4. Use provided hex wrench to fully tighten cap screws from **Step 2**.
 5. Loosen tailstock clamp handle, and slide tailstock back and forth over connection point.
- If tailstock catches where lathe and bed extension meet, loosen fasteners and repeat **Steps 3-5** until it slides smoothly.
6. Place straightedge over bed extension and lathe bed to verify they are parallel and aligned.

—If bed extension tilts *down*, use a strip of masking tape along *bottom* edge of lathe bed to shim bed extension up (see **Figure 4**), then adjust bed extension rubber feet to level bed surface.

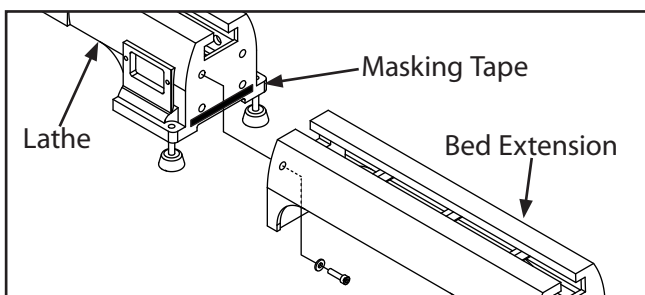

Figure 4. Shimming bed extension up.

—If bed extension tilts *up*, use a strip of masking tape along *top* edge of lathe bed to shim bed extension down (see **Figure 5**), then adjust rubber feet to level bed surface.

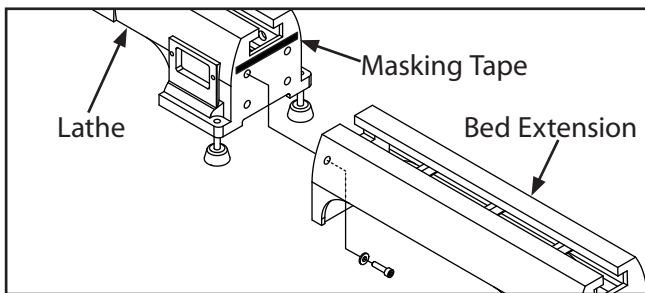

Figure 5. Shimming bed extension down.

—If bed extension is skewed left or right, use a vertical strip of masking tape along corresponding edge of lathe bed to make bed extension parallel with lathe bed (see **Figure 6**).

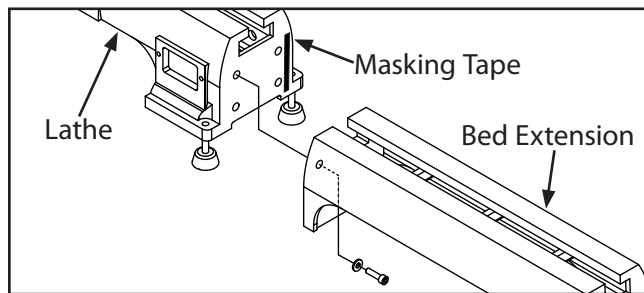
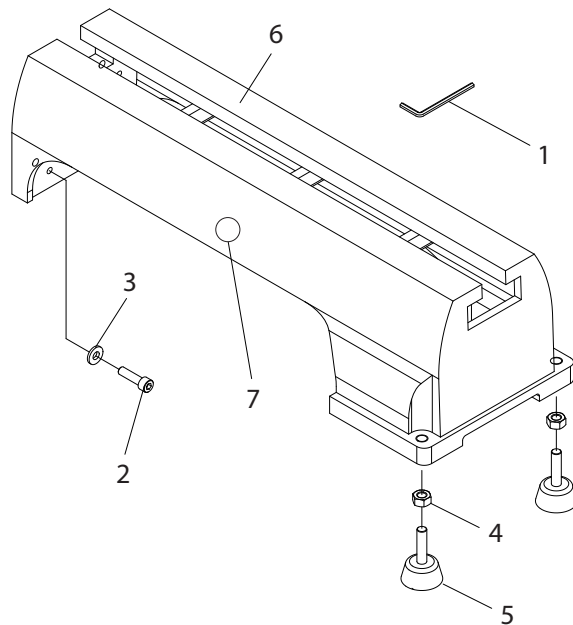

Figure 6. Shimming bed extension left.

Refer to Model ST1008 manual for instructions on operating lathe.

If you need help with your new bed extension, call our Tech Support at: (360) 734-3482.

ST1009 Parts Breakdown



REF	PART #	DESCRIPTION
1	XST1009001	HEX WRENCH 6MM
2	XST1009002	CAP SCREW M8-1.25 X 35
3	XST1009003	FLAT WASHER 8MM
4	XST1009004	HEX NUT 3/8-16
5	XST1009005	RUBBER FOOT
6	XST1009006	BED EXTENSION
7	XST1009007	SHOP FOX WHITE M1006